

## Stainless steel ball bearing butt hinge, 102 x 76 mm

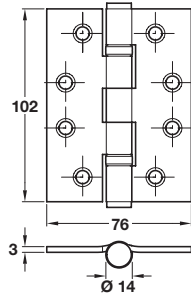

- > ANSI hole pattern
- > Maximum adjusted door weight 120 kg
- > For internal applications
- > Two high quality ball bearing race joints
- > CE marked
- > BS EN 1935, grade 13
- > Grade 201 stainless steel
- > Set consists of:
  - 3x Ball bearing butt hinges
- > Order qty: 1 set

BS EN 1935

4 7 6 1 1 4 0 13



Finish	Cat. No.
Electro-brassed	926.83.658

## Butt hinge, 75 x 49 mm

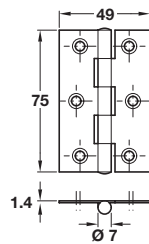

- > Fixed pin
- > For light/medium weight interior doors
- > Maximum door weight 25 kg (when 3 hinges used)
- > Fixings are included
- > Steel
- > Set consists of:
  - 20x Butt hinges
- > Order qty: 1 set

Finish	Cat. No.
Bright zinc-plated	926.60.068

## 466 Rising butt hinge, 76 x 73 mm

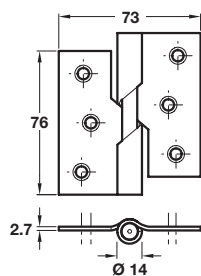
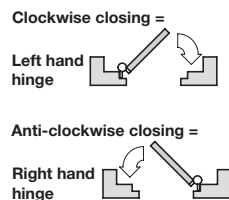

Note: ±3 mm tolerance on dimensions

- > Handed
- > Cranked knuckle
- > Lift-off pattern
- > Flush pin
- > For max. 37 kg door weight (when 3 hinges used)
- > Order fixing screws separately
- > Mild steel
- > Set consists of:
  - 2x Rising butt hinges
- > Order qty: 1 set

Finish	Left handed
Electro-brassed	926.83.558

## Broad style hinge, 63 x 35 mm

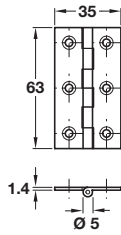

- > With fixed brass pin
- > For general purpose joinery and furniture where durable fittings are required
- > Solid drawn brass
- > Set consists of:  
2x Broad style hinges
- > Order qty: 1 set

Finish	Cat. No.
Polished brass	354.24.874

## Butt hinge, 104 x 58 mm

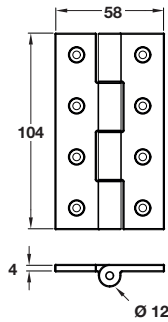

- > Cast iron
- > Set consists of:  
2x Butt hinges
- > Order qty: 1 set

Finish	Cat. No.
Black	926.83.123