

Spacer

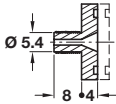

Spacer with expanding plug press-fit in drilled holes \varnothing 5 mm



Spacers to build up from the cabinet surface

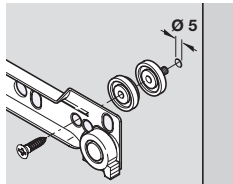
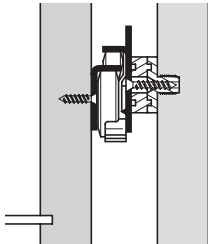
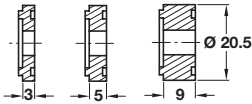

- > For placement between the profiles and cabinet side panels
- > For various installation widths or to compensate for door overhang
- > Order qty: Multiples of 100 pcs

Thickness	Cat. No.
4 mm, with plug	037.93.708
3 mm	037.93.717
5 mm	037.93.726
9 mm	037.93.735

Smuso soft and self closing mechanism, with follower for wooden drawers

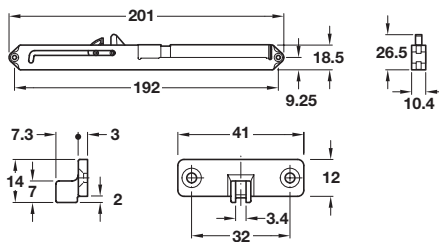

Installation
For roller and ball bearing runners

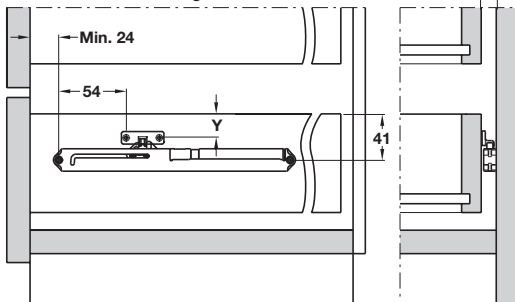

Gap width $S = 12$ to 15 mm
Not self closing (without lowering) $Y = 21$ mm
Self closing $Y = 23$ mm

For groove mounted runners

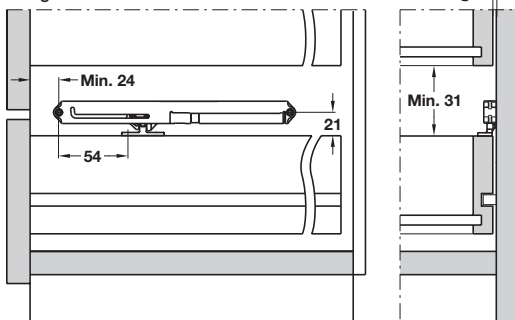

Gap width $S = 12$ to 15 mm

- > For use on roller runners, ball bearing runners without retainer retention or groove mounted runners
- > Max. 25 kg load bearing capacity with one sides installation or 50 kg with two sided installation
- > Installation: On one or both sides, soft and self closing mechanism for screw fixing to cabinet side panel, follower for screw fixing to drawer side
- > Light grey and black plastic
- > Order fixing screws separately
- > Order qty: 1 pc

- ! > The installation on one side or both sides is determined by the installation situation (width, depth, running properties and load bearing capacity of the runners)
- > Always use 2 soft closing mechanisms for drawers wider than 400 mm or if the drawer's depth exceeds its width

smuso

Version
With follower for wooden drawers

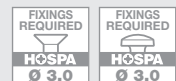

Cat. No.
432.13.507