

# AXIMAT 100 HINGES

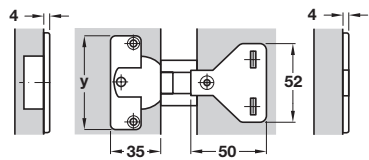

- > LGA tested project quality in compliance with DIN EN 15570 test level 3 (80,000 cycles)
- > Large opening angle from 180° to 250° provided by external pivot point (axle)
- > Almost no loss of space inside the cabinet due to the flat design
- > Door installation with slide on system
- > Cup for screw fixing or press fitting, hinge arm fixing into 32 mm series drilled holes
- > 2 dimensional adjustment facilities for alignment of the gap pattern
- > Cabinet construction or continuous construction possible
- > With integrated automatic closing spring
- > Side panel mounting
- > Nickel-plated zinc alloy



Drilling pattern for cup fixing

Drilling pattern for hinge arm fixing

For screw fixing

For screw fixing with chipboard screws

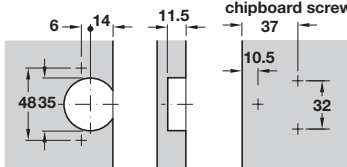

For press fitting

For screw fixing with Euro screws

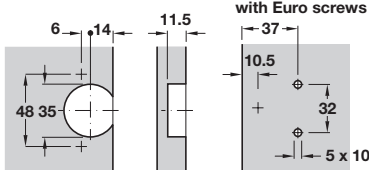

Drilling pattern 48/6

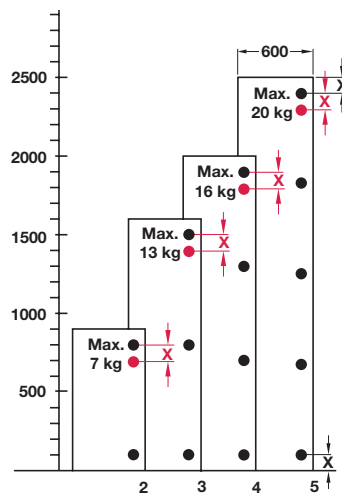

### Number of concealed hinges per door

The values in the diagram are sample measurements for doors up to 600 mm wide. Please inquire for doors wider than 600 mm

With doors under 400 mm wide the minimum gap must be determined by trial mounting

The door's width should not exceed its height

The distance between hinges of doors with two hinges must be at least as long as the door is wide, if possible even longer

In case of heavy loads and high leverage force, an additional hinge mounted approx. 100 mm (dim. X) below the top hinge is recommended

### Adjustment facilities

The two adjustment facilities allow correcting processing and installation deviations. Side and height adjustments are factory set to zero position

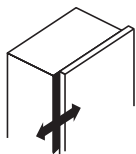

A Side adjustment

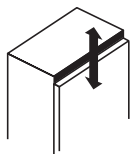

B Height adjustment

## Full overlay mounting

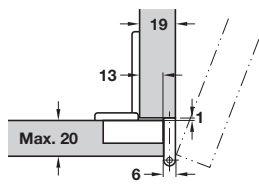

- > Order fixing screws separately for Hospa screw fixing versions
- > Order qty: 1 pc

**PART NUMBERS REMOVED**  
344.21.100



Arm fixing	Screw fixing cup	Press fitting cup
With pre-mounted Euro screws	344.21.010	344.21.110
Hospa screw fixing	344.21.000	-

## Half overlay mounting

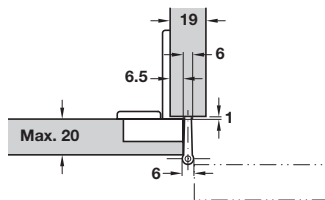

- > Order fixing screws separately for Hospa screw fixing versions
- > Order qty: 1 pc

**PART NUMBERS REMOVED**  
344.21.111



Arm fixing	Screw fixing cup	Press fitting cup
With pre-mounted Euro screws	344.21.011	-
Hospa screw fixing	344.21.001	344.21.101

## Twin mounting

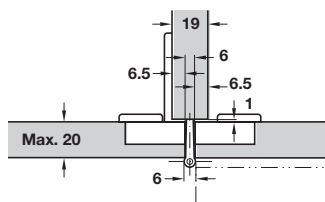

- > Order fixing screws separately for Hospa screw fixing versions
- > Order qty: 1 pc

**PART NUMBERS REMOVED**  
344.21.113  
344.21.103



Arm fixing	Screw fixing cup	Press fitting cup
With pre-mounted Euro screws	344.21.013	-
Hospa screw fixing	344.21.003	-