

CHATSWORTH knob

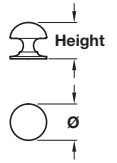

Note: ± 3 mm tolerance on non-critical dimensions and ±1 mm on hole centre dimensions

- > 1x M4 x 50 mm handle screw included
- > Brass
- > Order qty: 1 pc



Diameter	Height	Polished nickel	Brushed copper
Ø 31 mm	32 mm	134.97.710	-
Ø 38 mm	39 mm	134.97.711	134.97.011



Brushed copper has not been lacquered and will change naturally over time

4

Furniture Handles: Vintage

CHATSWORTH cup handle

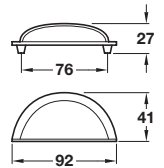

Note: ± 3 mm tolerance on non-critical dimensions and ±1 mm on hole centre dimensions

- > 2x M4 x 50 mm handle screws included
- > Brass
- > Order qty: 1 pc



Finish	Cat. No.
Polished nickel	151.07.701
Brushed copper	151.07.001



Brushed copper has not been lacquered and will change naturally over time

CHATSWORTH card frame cup handle

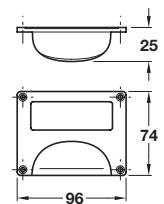

Note: ± 3 mm tolerance on non-critical dimensions and ±1 mm on hole centre dimensions

- > 4x Ø 6 x 19 mm slotted raised head screws
- > Brass
- > Order qty: 1 pc



Finish	Cat. No.
Polished nickel	168.10.700

TOH DESIGN 2017. © Häfele U.K. Ltd 2017. Dimensional data not binding. We reserve the right to alter specifications without notice.