

MILITARY ring pull handle

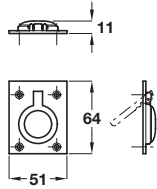

Note: ± 3 mm tolerance on non-critical dimensions and ±1 mm on hole centre dimensions

- > 4x Ø 3.5 x 20 mm raised head screws included
- > Brass
- > Order qty: 1 pc



Finish	Cat. No.
Polished nickel	161.21.711

MILITARY inset handle

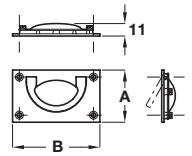

Note: ± 3 mm tolerance on non-critical dimensions and ±1 mm on hole centre dimensions

- > 4x Ø 3.5 x 16 mm raised head screws included
- > Brass
- > Order qty: 1 pc



Dim. A	Dim. B	Polished nickel	Polished brass
46 mm	76 mm	161.21.721	161.21.801
51 mm	91 mm	-	161.21.802
54 mm	100 mm	161.21.723	161.21.803

BROMLEY knob

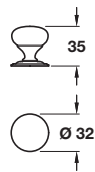

Note: ± 3 mm tolerance on non-critical dimensions and ±1 mm on hole centre dimensions

- > 1x M4 x 25 mm handle screw included
- > Brass
- > Order qty: 1 pc



Finish	Cat. No.
Polished nickel	134.97.701
Stainless steel effect	134.97.001

Cabinet latch

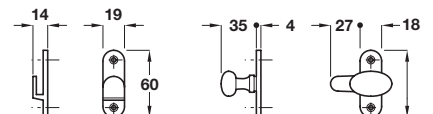

Note: ± 3 mm tolerance on non-critical dimensions and ±1 mm on hole centre dimensions

- > 4x Ø 3.5 x 16 mm raised head screws included
- > Brass
- > Order qty: 1 pc



Finish	Cat. No.
Polished nickel	252.76.700