

## Inset handle

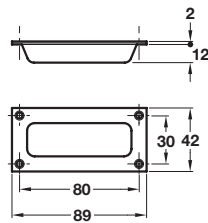

- > Internal lipping to suit both light duty straight sliding or folding doors
- > Order M4 handle screws separately
- > Brass
- > Order qty: 1 pc



Finish	Cat. No.
Satin chrome	151.10.600

## Inset handle

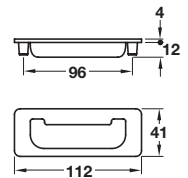

- > Order M4 handle screws separately
- > Zinc alloy
- > Order qty: 1 pc



Finish	Cat. No.
Polished chrome, aluminium coloured inside	151.15.205

## Inset handle

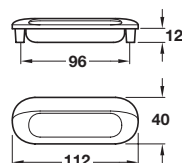

- > Order M4 handle screws separately
- > Zinc alloy
- > Order qty: 1 pc



Finish	Cat. No.
Polished chrome, aluminium coloured inside	151.17.209

## Pull handle

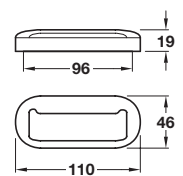

- > Order M4 handle screws separately
- > Zinc alloy
- > Order qty: 1 pc



Finish	Cat. No.
Aluminium coloured	151.37.256
Matt nickel	151.37.658