

CYLINDER CORES

- > Modular system allows the lock case to be premounted to the furniture before installation and the cylinders are added later
- > The same cylinder core will fit all the various designs of lock case
- > The combination tool on page **107** can be used to operate or test the locking mechanism of lock cores before the cylinder is added
- > Cylinder cores can be installed, repositioned or replaced quickly. Removal key is needed to remove the cylinder core
- > For correct locking direction cores turn clockwise to unlock and anti-clockwise to lock
- > Castings and cores are marked as diagram
- > When all markings are positioned identically, the doors/drawers will all operate with the same locking direction

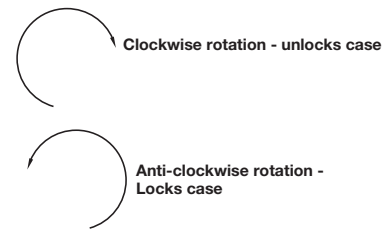

Modular system cylinder cores are only compatible with lock cases on pages **102-105**



These cylinders snap into all cylinder housings without using a change tool

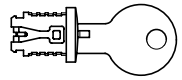

To install:
Line up lock so that key lines up with notch in cylinder housing as shown

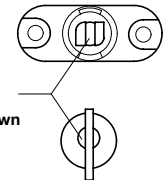

Modular system cylinder core

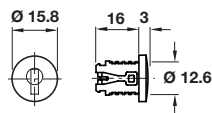

Insert cylinder core into cylinder housing and push until they snap together

Lock is now ready to use-to remove the cylinder core the removal key must be used

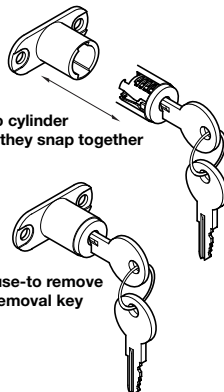

- > Suitable for all lock cases in the Module system
- > 5 plate levers = 200 possible key changes
- > Zinc alloy with brass lever plates
- > Accessories: 2 keys
- > Order qty: 1 pc

Finish	Nickel plated	Brass-plated
Keyed to differ	210.04.606	210.04.802
Keyed alike		
Key change 100T	210.04.615	210.04.811
Key change 101T	210.04.624	-
Key change 102T	210.04.633	-
Key change 103T	210.04.642	-
Key change 104T	210.04.651	-
Key change 105T	210.04.660	-
Key change 106T	210.04.679	-
Key change 107T	210.04.688	-
Key change 108T	210.04.697	-
Key change 109T	210.04.704	-
Master key for cylinder cores	210.02.059	-

Cylinder rosette

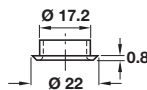

- > Must be ordered separately
- > Brass
- > Order qty: Multiples of 10 pcs

Finish	Nickel-plated	Brass-plated
Cat. No.	219.19.970	210.04.080

Removal key



- > For removing cylinder cores
- > Brass
- > Order qty: 1 pc

	Cat. No.
Removal key	210.02.004