

HÄFELE SYSTEM 1 INFRONT SLIDING DOOR SYSTEM

Straight sliding top hung inset cupboard doors, for budget domestic or light-duty commercial furniture.

- > Häfele System 1 infront Sliding door system
- > Range:
 - Max. door weight **15 kg**
 - Door thickness **16-20 mm**
- > Running gear has ± 2 mm adjustment

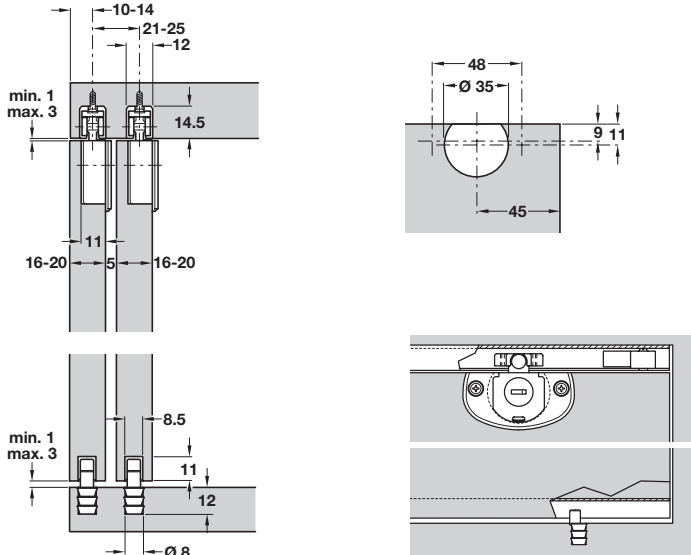

Häfele System 1 track

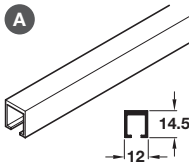

- > Order tracks and profiles separately
- A Top track, pre-drilled for mounting screws, silver anodised aluminium
- > Order qty: 1 pc (2.0 or 3.0 m length)



Item	2.0 m	3.0 m
A Top track	401.21.920	401.21.930

Häfele System 1 Infront fitting set for 2 doors

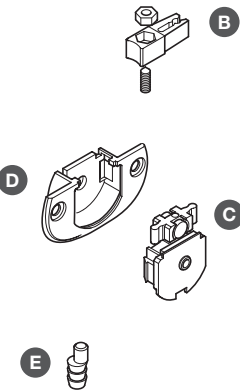

- > Fitting set includes:
 - B Track stopper for top track, 10 x 30 x 10 mm black plastic
 - C Running gear, clip on for use with housing D, black plastic
 - D Housing, screw fixing for use with running gear C, black plastic
 - E Bottom guide, press-fit for use with profile F, black plastic
- > Order qty: 1 set (order 1 set per pair of doors)



Item	For 2 doors
B Track stopper	4 pcs
C Running gear	4 pcs
D Housing	4 pcs
E Bottom guide	2 pcs
Cat. No.	401.20.000

Häfele System 1 guide profile

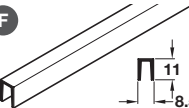

- > Order tracks and profiles separately
- F Bottom guide profile, off-white nylon
- > Order qty: 1 pc (2.0 m length)



Item	2.0 m
F Bottom guide profile	401.22.720

Häfele System 1, 2 door set with top and bottom tracks

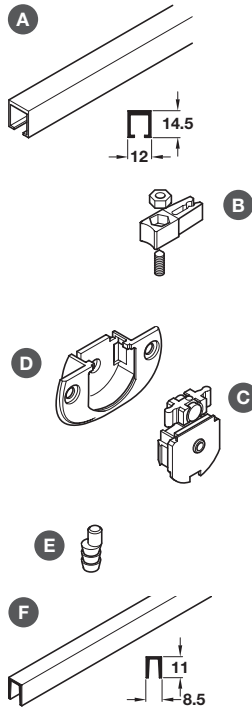

> Set includes:

A Top track, pre-drilled for mounting screws, silver anodised aluminium, 3.0 m

B Track stopper for top track, 10 x 30 x 10 mm black plastic

C Running gear, clip on for use with housing D, black plastic

D Housing, screw fixing for use with running gear C, black plastic

E Bottom guide, press-fit for use with profile F, black plastic

F Bottom guide profile, off-white nylon, 2.0 m

> Order qty: 1 set



Item	For 2 doors
A Top track	1 pc
B Track stopper	4 pcs
C Running gear	4 pcs
D Housing	4 pcs
E Bottom guide	2 pcs
F Bottom guide profile	1 pcs
Cat. No.	402.20.006