

- **Modular system** allows the lock case to be premounted to the furniture before installation and the cylinders are added later
- The same cylinder core will fit all the various designs of lock case
- The combination tool on page 7 can be used to operate or test the locking mechanism of lock cores before the cylinder is added
- Cylinder cores can be installed, repositioned or replaced quickly. Removal key is needed to remove the cylinder core
- For correct locking direction cores **turn clockwise to unlock** and **anti-clockwise to lock**
- Castings and cores are marked as diagram
- When all markings are positioned identically, the doors/drawers will all operate with the same locking direction

These cylinders snap into all cylinder housings without using a change tool

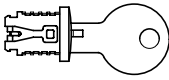

To install:  
Line up lock so that key lines up with notch in cylinder housing as shown

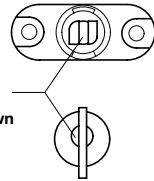

Insert cylinder core into cylinder housing and push until they snap together

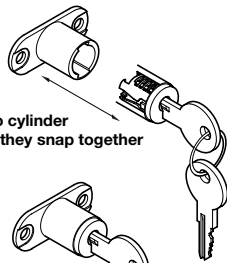

Lock is now ready to use-to remove the cylinder core the removal key must be used

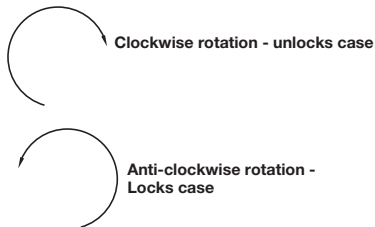

### A Modular system cylinder core

- Suitable for all lock cases in the Module system
- **5 plate levers** = 200 possible key changes
- Zinc alloy with brass lever plates
- **Accessories:** 2 keys

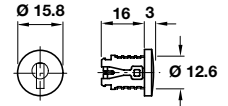

Random key changes			
Finish	Nickel-plated	Brass-plated	Black
Cat. No.	210.04.606	210.04.802	210.04.302
Keyed alike			
Finish	Nickel-plated	Brass-plated	Black
Key change 100T	210.04.615	210.04.811	210.04.311
Key change 101T	210.04.624		
Key change 102T	210.04.633		
Key change 103T	210.04.642		
Key change 104T	210.04.651		
Key change 105T	210.04.660		
Key change 106T	210.04.679		
Key change 107T	210.04.688		
Key change 108T	210.04.697		
Key change 109T	210.04.704		
Master key for cylinder cores:			
Cat. No.	210.02.059		

Order qty: 1 pc

### B Cylinder rosette

- Must be ordered separately
- Brass

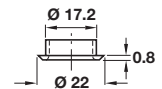

Finish	Cat. No.
Nickel-plated	219.19.970
Brass-plated	210.04.080
Black	210.04.035

Order qty: Multiples of 10 pcs

### C Removal key

- For removing cylinder cores
- Brass



	Cat. No.
Removal key	210.02.004

Order qty: 1 pc