

## Hinge adapter

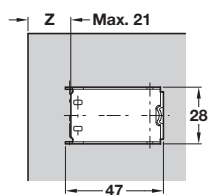

Dimensions for adapter overlay:  
**Z = Door overlay + 7 mm**  
 with mounting plate, height 0 mm

- > Glued into position, no need to route or drill the door
- > Stainless steel
- > Order qty: 1 pc

	Cat. No.
Hinge adapter	322.38.690*

## Cruciform mounting plate

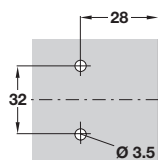

- > For click on MIRRO mirror hinge
- > 28 mm backset
- > Hospa screw fixing
- > One part plate
- > Nickel-plated pressed steel
- > Order qty: 1 pc

Height	Cat. No.
0 mm	322.97.720

## Soft close adapter



- > For use with MIRRO mirror hinge with spring, Cat. No. 322.39.600
- > Dimensions: 60 x 20 x 25 mm (HxWxD)
- > Order qty: 1 pc



> For use with MIRRO mirror hinge shown on page **104**

Height	Cat. No.
Nickel plated	322.67.195