

SYMO 3000 ESPAGNOLETTE LOCK CASES

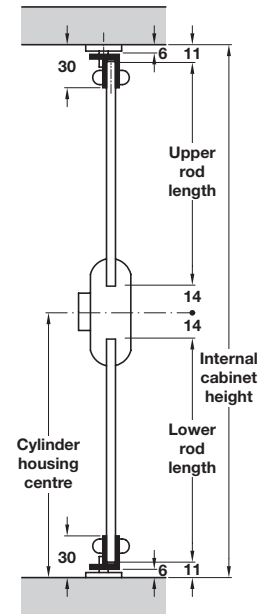

Maximum rod dimensions:

Upper rod length
= cylinder housing centre - 25 mm

Lower rod length
= cylinder housing centre - 25 mm

Symo 3000 Piccolo-Nova lock case



15 mm backset

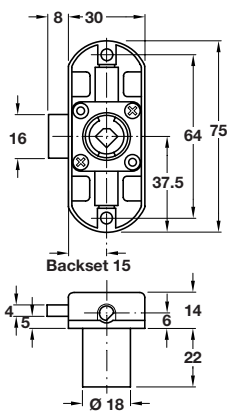

25 mm backset

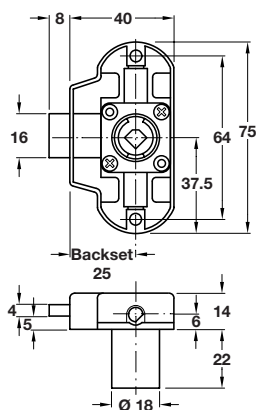

- > For on-site installation of cylinder cores
- > Backset: 15 or 25 mm
- > Screw fixing
- > For Ø 6 mm divided profile rod
- > Left or right handed
- > Nickel-plated zinc alloy
- > Order qty: 1 pc



> Order cylinder rosette separately, shown on page **249**

Backset	Left	Right
15 mm	224.64.650	224.64.600
25 mm	224.64.660	224.64.610

- > Espagnolette lock accessories for Ø 6 mm profile rod suitable for Symo are shown on pages **241-243**
- > Lock handles for Symo 3000 lock cases are shown on page **192**
- > Cylinder cores for Symo 3000 lock cases are shown on pages **193-196**