

Open bar guide

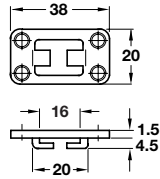

- > Suitable for surface or recess mounting
- > Steel
- > Order qty: Multiples of 10 pcs



Finish	Cat. No.
Galvanized	237.23.006

Arresting pins

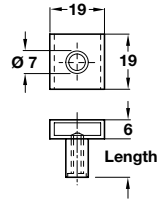

- > For general purpose use
- > Matt nickel-plated zinc alloy
- > Accessories: 1x grub screw
- > Order qty: Multiples of 10 pcs

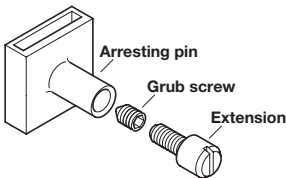

> Extension not included.
Extensions to the 13 mm pin are shown below

Length	Cat. No.
6.5 mm	237.22.120
13.0 mm	237.22.100

Extension for arresting pins

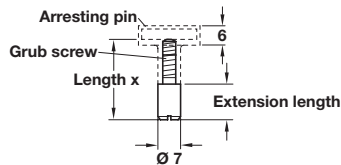

- > With M4 thread
- > Screw fits into grub screw of arresting pins
- > Galvanized steel
- > Order qty: Multiples of 10 pcs



> Please note: Length X includes extension length

Length X	13 mm	16 mm	21 mm	26 mm
Ext. length	3 mm	6 mm	11 mm	16 mm
Cat. No.	237.22.189	237.22.214	237.22.269	237.22.312

Central locking bar

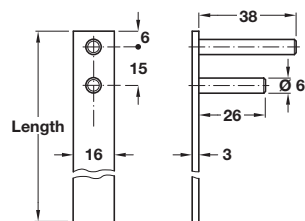

- > Bar can be cut to length
- > Bright aluminium
- > Order qty: 1 pc

Length	Cat. No.
600 mm	237.10.002
800 mm	237.10.004
1000 mm	237.10.006
1500 mm	237.10.009