

## IXCONNECT RAFIX-20 CONNECTOR HOUSINGS

ixconnect

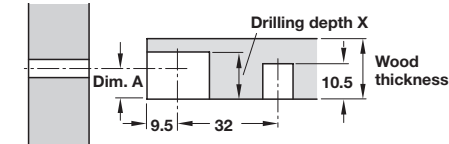

**Drilling depth X** = depends on type of housing and wood thickness (see order columns for details)  
**Dimension A** = 1/2 wood thickness (see order columns for details)

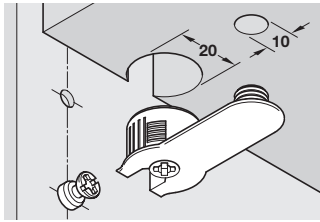
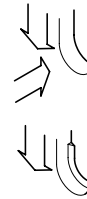

**Without ridge:**  
The horizontal panel can be installed end-on or from above

**With ridge:**  
The horizontal panel can only be installed from above and the cabinet elements are pre-assembled

### Rafx-20 housing, zinc alloy

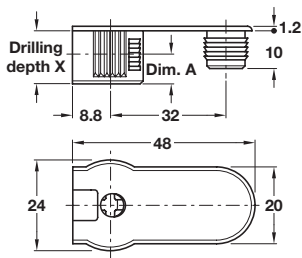

- > For wood thickness from 16 or 19 mm
- > Zinc alloy housing with zinc alloy tightening element
- > Order qty: Multiples of 100 pcs

For wood thickness from	Dim. A	Drilling depth X	Nickel-plated
<b>Without ridge</b>			
16 mm	8.0 mm	12.7 <sup>+0.2</sup> mm	263.13.703
19 mm	9.5 mm	14.2 <sup>+0.2</sup> mm	263.13.705
<b>With ridge</b>			
16 mm	8.0 mm	12.7 <sup>+0.2</sup> mm	263.17.703
19 mm	9.5 mm	14.2 <sup>+0.2</sup> mm	263.17.705

### Rafx-20 housing, plastic

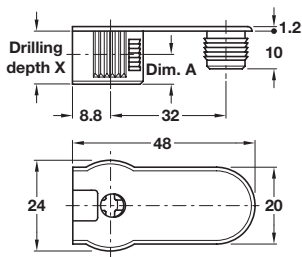

- > For wood thickness from 16 or 19 mm
- > Plastic housing with zinc alloy tightening element
- > Order qty: Multiples of 100 pcs

Dim. A	Drilling depth X	White	Silver coloured	Black	Beige	Brown
<b>Without ridge - for wood thickness 16 mm</b>						
8.0 mm	12.7 <sup>+0.2</sup> mm	263.12.703	263.12.203	-	263.12.403	-
<b>Without ridge - for wood thickness 19 mm</b>						
9.5 mm	14.2 <sup>+0.2</sup> mm	263.12.705	-	263.12.305	263.12.405	263.12.105
<b>With ridge - for wood thickness 19 mm</b>						
9.5 mm	14.2 <sup>+0.2</sup> mm	263.16.705	-	-	-	-



- > Rafx-20 connecting bolts, suitable for these housings are shown on pages **313-315**
- > Red jig for Rafx-20 housings are shown on **321-324**
- > Unitool drilling jig for Rafx-20 housings can be found on page **325-326**
- > Variantool-N drilling jig for drilling series-drilled holes for connecting bolts shown on page **322**
- > Rafx-20 housings without dowel shown on page **310**