

## HAWA-FOLDING CONCEPTA 25

Folding and pivot sliding system for bi-folding cabinet pocket doors. Flush cabinet fronts can be fully opened from end to end to give complete access to cabinet contents but are also completely concealed once doors are opened.

- > Based on the HAWA-Concepta the system is for bi-folding pocket doors
- > Two pairs of folding doors enable cabinet fronts up to 2800 mm in width to be stored in the cabinet
- > Opened: free access to the entire cabinet front  
Closed: flush with the adjacent areas
- > The folding door pair can be pushed in fully flush with the external side
- > Range:
  - Max. door weight **25 kg** (per pair of panels 50 kg)
  - Door width **300-700 mm**
  - Door height **1250-2600 mm**
  - Door thicknesses **19-28 mm**
- > Features:
  - Low slide-in loss of 73 mm in the cabinet depth
  - Continuous gap pattern and uniform front designs, also in combination with HAWA-Concepta 25/30/40/50 and pivot doors
  - Room high designs without a cabinet base allow for recess enclosures and walk-in cabinets with uninterrupted flooring
  - Cabinet designs from worktop to ceiling are possible
  - All adjustments are made from the front
  - Integrated cabinet body and side connectors simplify the installation of cabinets with overlaying fronts
  - Unique scissor technology prevents any jamming when folding and sliding

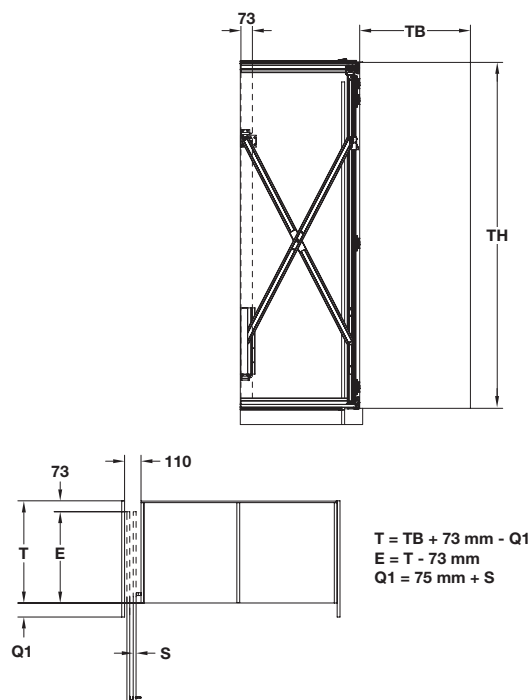

## Design with an overlaying cabinet front

- > The optionally available base profile, shown on page 295, enables the design of simple cabinet bodies with an overlaying cabinet front
- > The leading ramp included with the base profile set positions the doors flush with adjacent areas

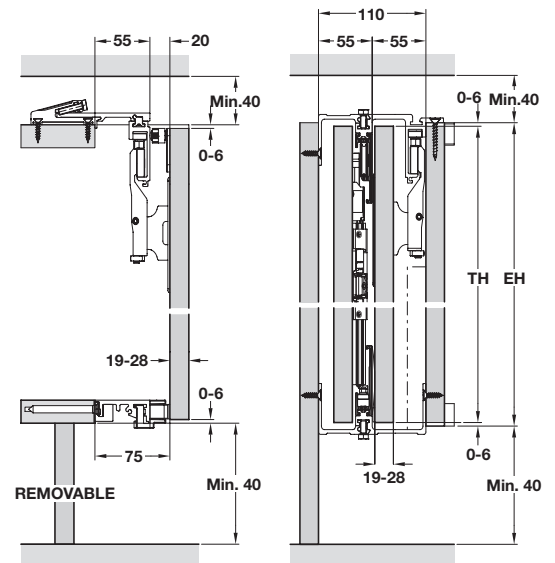
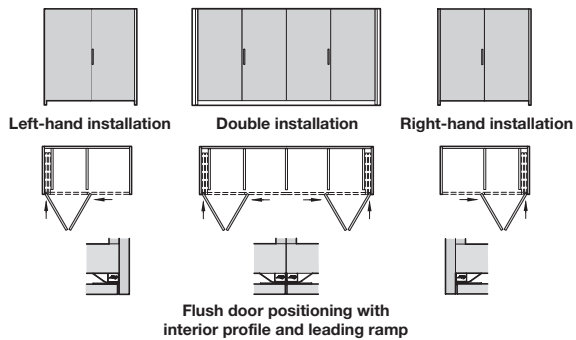

## Design with recess cover without a base and with a ceiling connection

- > Room high cabinet designs without a base allow to close off recesses with gaps of just 20 mm from door to floor and 40 mm from door to ceiling
- > It is also possible to design walk-in cabinets with uninterrupted flooring

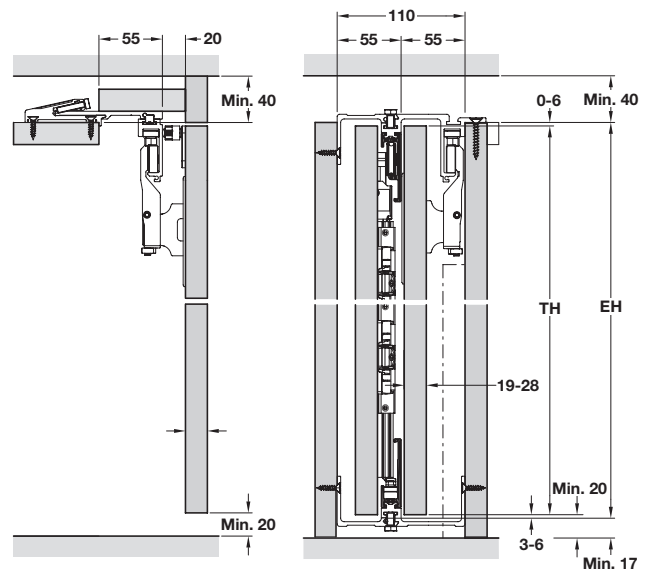
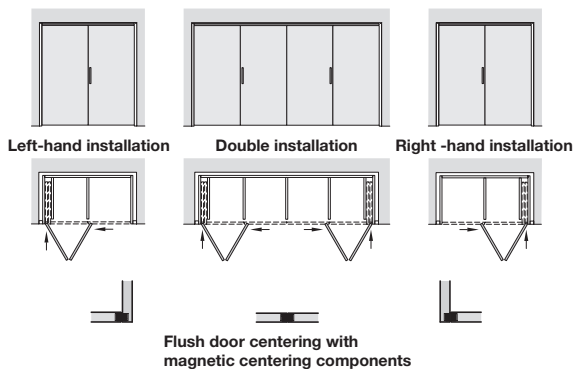

## Doors reaching from the worktop to the upper cabinet edge

- > Design options with semi height bi-folding pocket doors reaching from the worktop to the ceiling demonstrate the extensive flexibility of this system

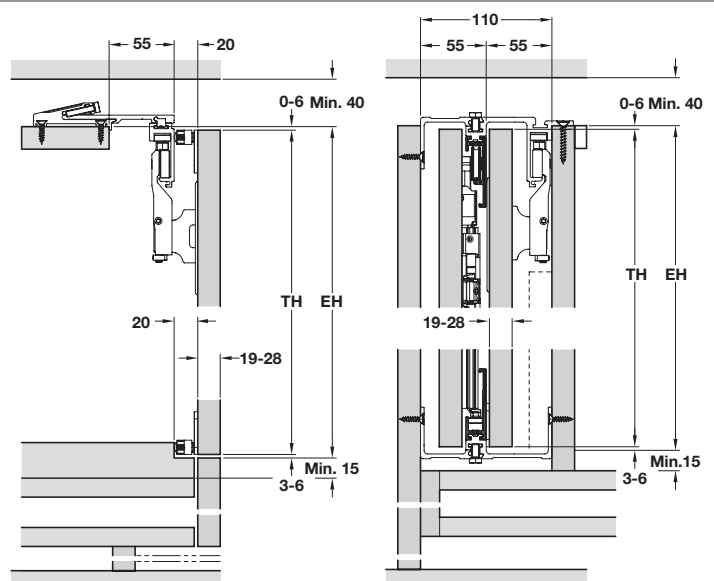
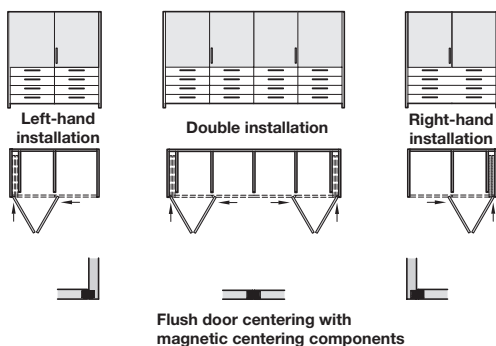

## HAWA-Folding Concepta 25 fitting sets

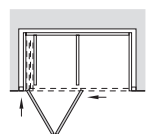

Left hand installation

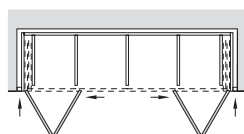

Double installation

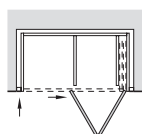

Right hand installation

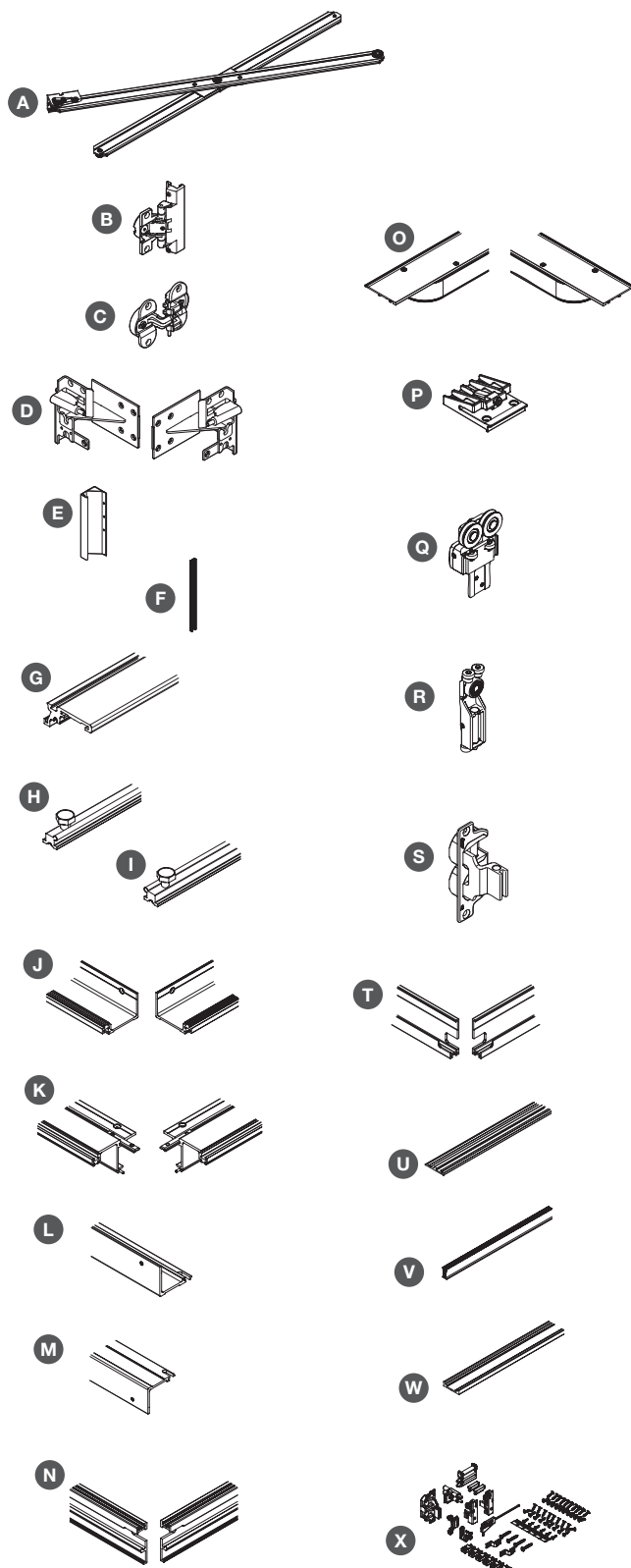

- > The HAWA-Folding Concepta set for one bi-folding door pair includes all the hardware components, scissor and top track
- > Sets are handed left and right and available for door heights of 1250-1850 mm and also 1851-2600 mm
- > Top track and bottom profile are fitted easily from the front
- > Set includes
  - A Pivot scissor assembly, galvanized steel, 900 or 1500 mm height
  - B Concealed hinge, spring-loaded, for wooden door, galvanized steel, 3 or 4 pcs
  - C Concealed centre hinge, matt nickel finish, 3 or 4 pcs
  - D Rear scissor bearing, galvanized steel, left or right hand
  - E Rear scissor guide, anodized aluminium, 1 pc
  - F Front scissor guide, anodized aluminium, 1 pc
  - G Upright, anodized aluminium, 1800 or 2500 mm height
  - H Connector connecting profile, bottom left/top right, 500 mm, anodized aluminium, 1 pc
  - I Connector connecting profile, bottom right/top left, 500 mm, anodized aluminium, 1 pc
  - J Interior connector, bottom, 645 mm, anodized aluminium, left or right hand
  - K Interior connector, top, 645 mm, anodized aluminium, left or right hand
  - L Exterior connecting profile, bottom left/top right, 645 mm, anodized aluminium, 1 pc
  - M Exterior connecting profile, bottom right/top left, 645 mm, anodized aluminium, 1 pc
  - N Top track, 748 mm, anodized aluminium, left or right hand
  - O Top track with curve, anodized aluminium, left or right hand
  - P Adapter for top track, plastic, anthracite-grey, 4 pieces
  - Q Trolley hanger, with 2 plastic-tyred ball bearing wheels, height-adjustable, dull nickel finish, 1 pc
  - R Trolley hanger, for folding door, with 2 plastic-tyred ball bearing wheels, height-adjustable, dull nickel finish, 1 pc
  - S Concealed press-fit cup, dull nickel finish, 1 pc
  - T Bottom guide channel, 748 mm, anodized aluminium, left or right hand
  - U Profile, black plastic, 1 pc, 1850 or 2620 mm height
  - V Guide brush, 10 mm height, black, 1 pc, 1850 or 2620 mm height
  - W Covering screen for panel clearance, anodized aluminium, 1870 or 2620 mm height
  - X Spare parts set, for 1250-1850 or 1851-2600 mm door height, handed
- > Order qty: 1 set

Special Order

For door height	REPLACES	Left hand	Right hand	REPLACES
1250-1850 mm	408.30.006	408.30.019	408.30.020	408.30.007
1851-2600 mm	408.30.008	408.30.021	408.30.022	408.30.009

## HAWA-Folding Concepta 25 channel

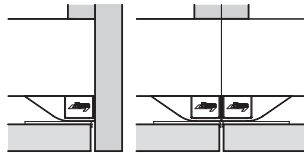
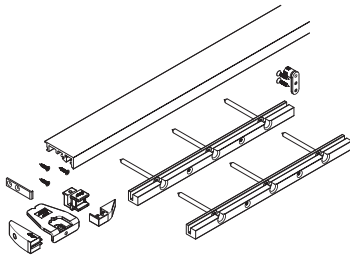

Flush door positioning with base profile and leading ramp

- > 1300 mm length profile with cover cap, leading ramp and drilling jig included
- > Leading ramp brings overlaying cabinet front flush into position
- > Anodised aluminium
- > Order qty: 1 set

Special Order

Door positioning profile

Cat. No.  
408.30.961

## HAWA-Folding Concepta 25 magnetic centering device

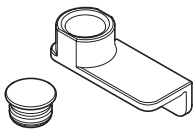

Flush door positioning with magnetic centering parts

- > For centering doors on recess designs or walk-in cabinets without a cabinet base
- > Drilling jig included
- > Anodised aluminium
- > Order qty: 1 set

Special Order

Magnetic centering device

Cat. No.  
408.30.229

## HAWA-Folding Concepta 25 reinforcement profile and plate

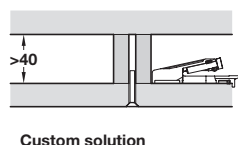
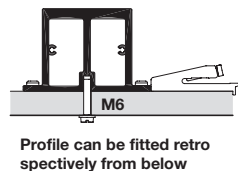
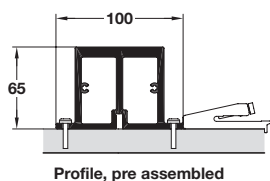
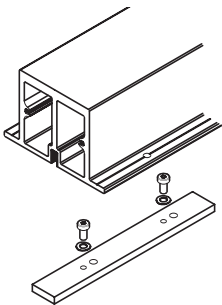

- > For double systems of up to 2800 mm without a centre section by means of profile which reinforces the cabinet top ceiling
- > Max. deflection of the cabinet ceiling: Max. 2 mm
- > Connection plate included for stabilising the top track butt joint between left and right sections and keeps it flush
- > Anodised aluminium
- > Order qty: 1 pc

Special Order

Reinforcement profile and plate

Cat. No.  
408.30.970



> Important: The re-inforcing profile for the top rail is required for applications using two double doors on same cabinet without a centre section.