

Koala concealed cabinet hanger, screw fixing

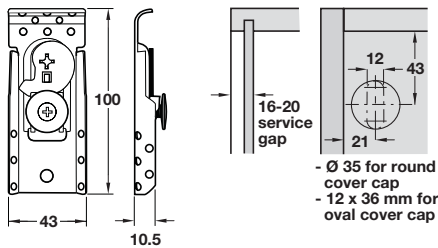

- > Unhanded
- > Cabinet hanger concealed behind rear panel, only cover cap visible inside the cabinet
- > A 3.5 x 20 mm lateral wood screw permanently secures the cabinet hanger in place (not provided)
- > Load carrying capacity 260 kg per pair (Load carrying capacity applies to 2 cabinet hangers bearing an evenly distributed load in accordance with regulation DIN 68840)
- > Three-way adjustment:
Vertical adjustment: 11 mm
Horizontal adjustment: 10 mm
Lateral adjustment: 12 mm
- > Zinc-plated steel
- > Order qty: 1 pc

Positioning

Fixing

Vertical and Horizontal adjustments

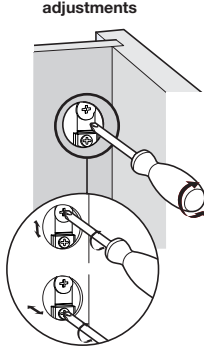
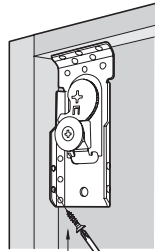
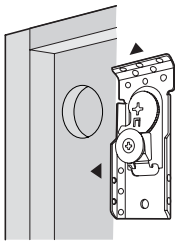

Cabinet hangers should only be adjusted with a hand tool and not a power tool

wood screw 3.5 x 20 mm



Wall plates and cover caps must be ordered separately, shown below

	Cat. No.
Koala cabinet hanger	290.36.920

Double wall fixing plate, for Koala concealed cabinet hanger

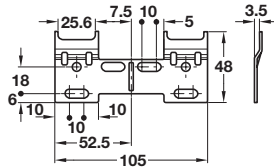

- > For use with Koala cabinet hanger 290.36.920
- > To split in two parts
- > Steel
- > Order qty: 1 pc

Finish	Cat. No.
Zinc-plated	290.36.925

Wall fixing plate, for Koala concealed cabinet hanger

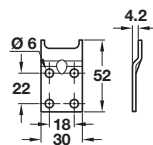

- > For use with Koala cabinet hanger 290.36.920
- > Steel
- > Order qty: Multiples of 10 pcs

Finish	Cat. No.
Zinc-plated	290.35.920

Round cover cap for Ø 35 mm hole, for Koala concealed cabinet hanger

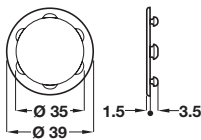

Round cover cap for Ø 35 mm hole

- > For use with Koala cabinet hanger 290.36.920
- > Plastic
- > Order qty: Multiples of 100 pcs

Finish	Round	Oval
Silver	290.36.980	-
Beige	290.36.480	-
White	290.36.780	-
Brown	290.36.180	-
Nickel-plated zinc alloy	-	290.36.770

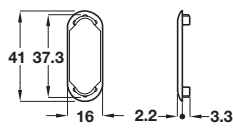

Oval cover cap for 12 x 36 mm hole