

FSB 4252 flush pull handle, stainless steel

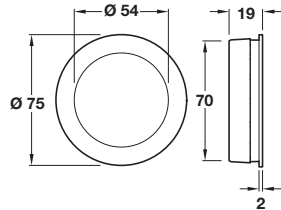

- > With sprung cover
- > Press-fit into a Ø 70 mm hole
- > Stainless steel
- > Order qty: 1 pc

Finish	Cat. No.
Satin stainless steel	902.00.366

Flush pull handle, stainless steel

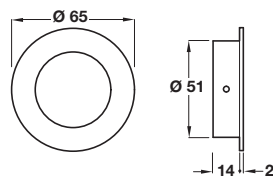

- > Secret fixing
- > Stainless steel
- > Order qty: 1 pc



Finish	Cat. No.
Satin stainless steel	902.00.520
Polished stainless steel	902.00.521

StarTec Flush pull handle, stainless steel

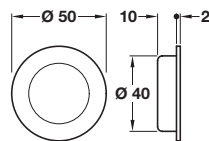

- > Push fit installation
- > Stainless steel
- > Order qty: 1 pc

Finish	Cat. No.
Satin stainless steel	902.01.250

StarTec Flush pull handle, stainless steel

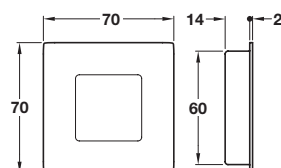

- > Suitable for use on sliding timber doors
- > Stainless steel
- > Order qty: 1 pc



Finish	Cat. No.
Satin stainless steel	902.01.260