

Startec NAPA lever handles, zinc alloy

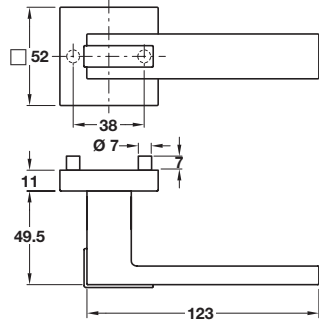

- > Pair of lever handles and roses
- > Grub screw fixing on 8 mm spindle
- > Sprung, for use with standard followers
- > To suit doors 36-44 mm thick
- > Zinc alloy
- > Order qty: 1 pair



Finish
Polished chrome/satin nickel-plated

Cat. No.
900.21.202

Startec DION lever handles, zinc alloy

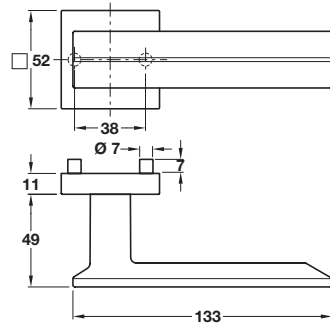

- > Pair of lever handles and roses
- > Grub screw fixing on 8 mm spindle
- > Sprung, for use with standard followers
- > To suit doors 36-44 mm thick
- > Zinc alloy
- > Order qty: 1 pair



Finish
Polished chrome/satin nickel-plated

Cat. No.
900.21.402

Startec SIENNA lever handles, zinc alloy

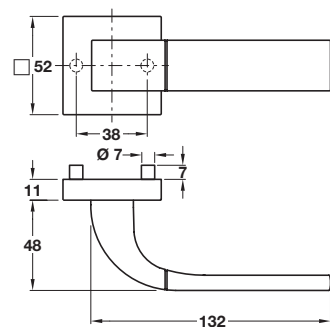

- > Pair of lever handles and roses
- > Grub screw fixing on 8 mm spindle
- > Sprung, for use with standard followers
- > To suit doors 36-44 mm thick
- > Zinc alloy
- > Order qty: 1 pair



Finish
Polished chrome/satin nickel-plated

Cat. No.
900.21.752



Co-ordinating escutcheons and WC/emergency release also available see page 69