

# TAMBOUR DOOR FITTINGS

Plastic fittings and tracks to create tambour doors, with stainless steel top trim. For cabinet door requirements where space is at a minimum. The door shutter folds away neatly and is concealed when open.

- > Maximum size of tambour shutters as illustrated.
- > Please note: The maximum height must not exceed 1.2 m
- > To calculate shutter dimensions:  
Shutter length = Internal cabinet height + 30 mm
- > Ensure shutter is long enough to extend beyond the bend in the track when closed
- > Shutter width = Internal cabinet width + 14 mm

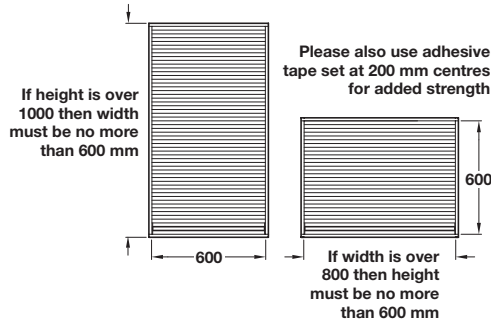
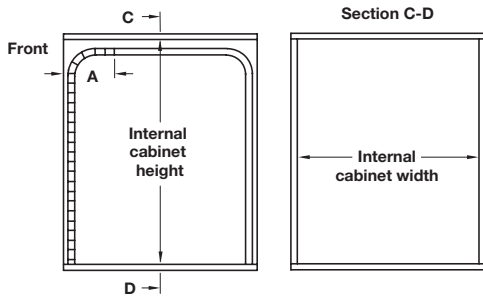

## Tambour top trim

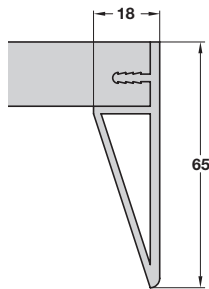
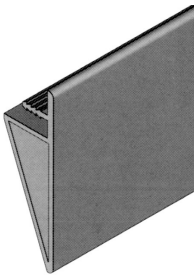

Stainless steel  
Aluminium colour

- > Stainless steel
- > Order qty: 1 pc

Finish	Cat. No.
Stainless steel	442.64.904
Aluminium colour	442.64.004

## Tambour door slats

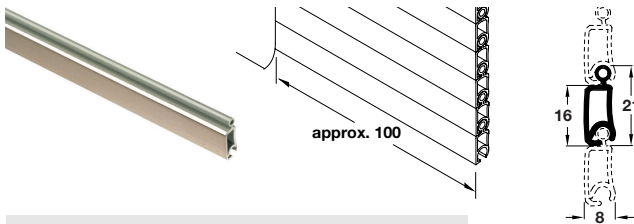

- ! > Priced and sold in metres. Please order in multiples of 2.5 metres

- > For slide in assembly to form a roller shutter
- > Max. height 1.2 m, max. width 1000 mm. If height 1000 mm, max. width 600 mm
- > Plastic
- > Order qty: Multiples of 2.5 metres

Finish	Cat. No.
Stainless steel	442.63.025
Aluminium colour	442.63.925

## Cotton adhesive tape

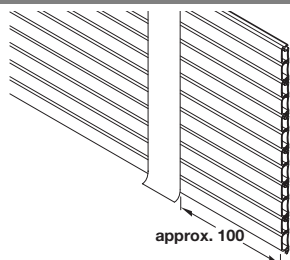

- > To reinforce shutters assembled from slats
- > 10 m length, 38 mm width
- > Recommended shutter reinforcement up to 900 mm wide - 2 strips
- > Order qty: 1 pc

Finish	Cat. No.
Cotton adhesive tape	442.01.088

## Tambour door handle profile



> Priced and sold in metres: Please order in multiples of 2.5 metres

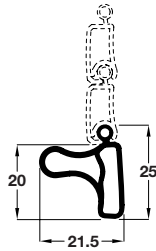

- > Plastic
- > Order qty: Multiples of 2.5 metres

Finish	Cat. No.
Stainless steel	442.61.906
Aluminium colour	442.61.006

## Tambour door handle end caps

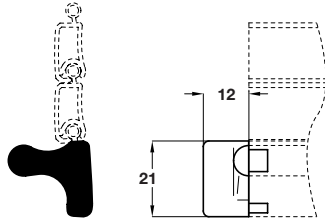

- > Order left and right hand separately
- > Plastic
- > Order qty: 1 pc

Finish	Left hand	Right hand
Stainless steel	442.61.991	442.61.990
Aluminium colour	442.61.091	442.61.090

## Running track

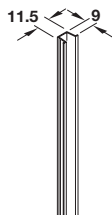

> Priced and sold in metres: Please order in multiples of 2.5 metres

- > With rim for groove-mounting
- > Plastic
- > Order qty: Multiples of 2.5 metres

Finish	Cat. No.
Grey	442.54.501

## 90° bend

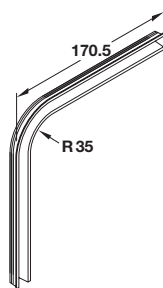

- > With rim radius = 35 mm, for groove mounting compatible with guide rail
- > Plastic
- > Order qty: 1 pc

Finish	Cat. No.
Grey	442.55.500

## End stop

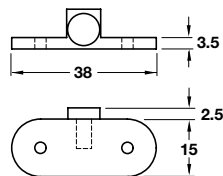
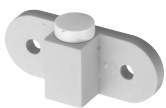

- > Screw-mounted, restrains the roller shutter when open and prevents impact damage to lock strip
- > Plastic with soft plastic buffer
- > Order qty: 1 pc

Finish	Cat. No.
Grey	442.01.005

## Centre stop

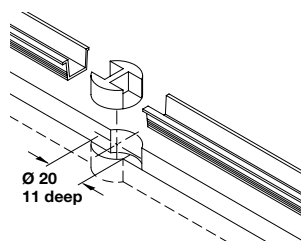

- > Recess mounted
- > Used to prevent shutters overriding their travel limits when open
- > White plastic
- > Order qty: 1 pc

Centre stop	Cat. No.
	442.01.014