

## Stainless steel hinge, ball bearing, 102 x 76 mm

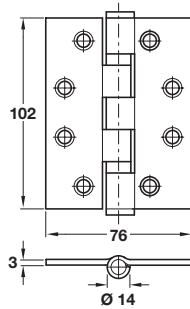

- > ANSI pattern
- > Maximum adjusted door weight - 120 kg
- > Square corners
- > Two high quality ball bearing race joints
- > Stainless steel
- > Order qty: 1 pc

GRADE  
**13**  
BS EN 1935

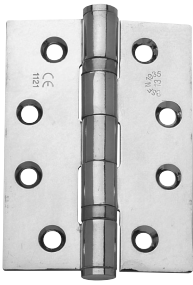

Fixings  
included

Finish  
Satin stainless steel

Cat. No.  
926.90.130

## Stainless steel DSSW butt hinge, 76 x 50 mm

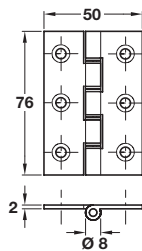
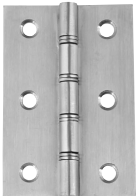

- > Maximum door weight - 40 kg
- > Square corners
- > Stainless steel washers to each joint
- > Stainless steel
- > Order qty: 1 pc

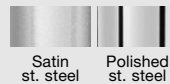

Fixings  
included

Finish  
Satin stainless steel  
Polished stainless steel

Cat. No.  
926.83.210  
926.83.211

## Stainless steel DSSW butt hinge, 100 x 66 mm

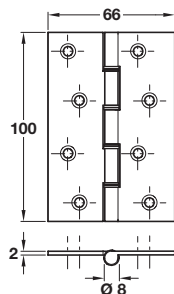

- > Square corners
- > Stainless steel washers to each joint
- > Stainless steel
- > Order qty: 1 pc



Fixings  
included

Finish  
Satin stainless steel  
Polished stainless steel

Cat. No.  
926.83.220  
926.83.221



Copper finishes are also available to order on request - please contact us for further information

PAGE AMENDED  
21.07.16/1