

High Security Cam-Lok sliding sash window lock

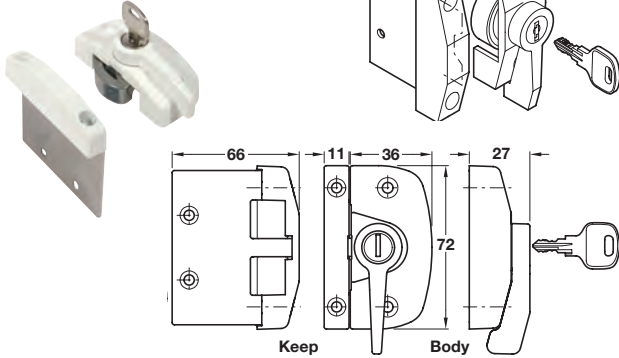

- > Suitable for most timber, aluminium and PVCu sash windows
- > Lateral and vertical seal compression
- > Easy fixing
- > Flat plate keep not included. Order separately
- > Diecast zinc alloy
- > Order qty: 1 pc

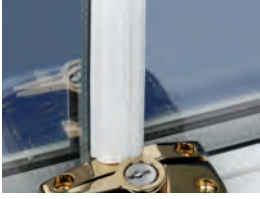
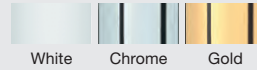

EXCEEDS
BS 7950
SECURITY

Finish	Body	Keep
White	971.00.587	971.00.597
Chrome	971.00.582	971.00.592
Gold	971.00.588	971.00.598

Cam-Lok sliding sash window lock

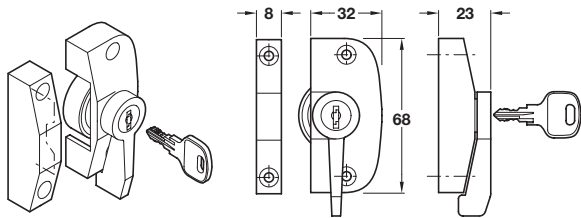

- > Locking and non-locking versions available
- > Suitable for timber, aluminium and PVCu sash windows
- > Lateral and vertical seal compression
- > Easy fixing
- > Flat plate keep included
- > Diecast zinc alloy
- > Order qty: 1 pc

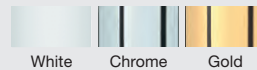

Finish	Locking	Non-locking
White	971.00.067	971.00.077
Chrome	971.00.062	971.00.072
Gold	971.00.068	971.00.078

Sash-Lok sash window restrictor

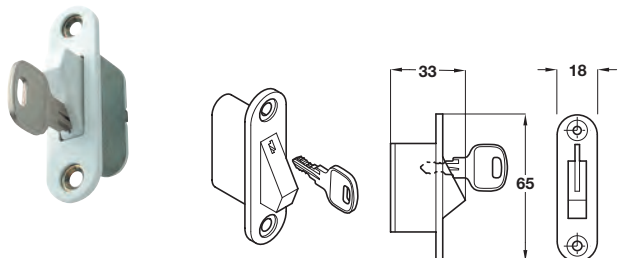
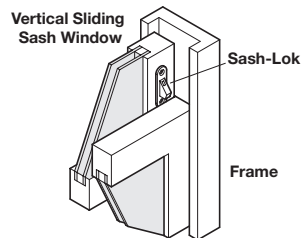

- > Suitable for most timber, aluminium and PVCu sash windows
- > Automatic engagement
- > Automatic locking
- > Keyed or non-keyed release
- > 1 No. key included
- > Restricts sash to 100 mm opening
- > Steel and plastic
- > Order qty: 1 pc

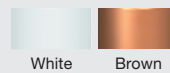

CONFORMS TO
BS EN
8213-1:2004

COMPLIES WITH
BS 6375
PART 2

Finish	Keyed	Non-keyed
White	973.00.007	973.00.897
Brown	973.00.001	973.00.891