

K PUSH TECH CONCEALED

Concealed fixing. Push system for opening doors without handles.



Recess mounted



Surface mounted - order fittings separately

K Push tech concealed short

K Push tech short with magnet, anthracite

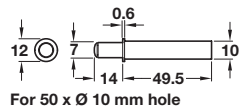

K Push tech short surface mount fitting, anthracite

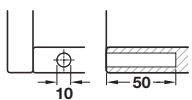
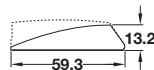
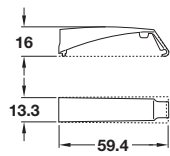

Recess mounted - short

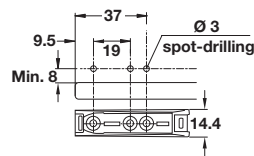

Surface mounted - short

- > Mechanism provides a silent yet powerful operation
- > Suitable for a wide range of doors
- > For installation in a Ø 10 mm hole or order surface mount fitting separately
- > Available either with magnet or with buffer
 - Order magnet version for cabinets using unsprung or negative hinges
 - Order buffer version for cabinets using sprung hinges
- > Important: please do not press or release the spring until the K Push is fully installed
- > Grey, white or anthracite engineering plastic with magnet or rubber buffer
- > Order qty: 1 pc



	Grey	White	Anthracite
With buffer	356.12.510	356.12.710	356.12.310
With magnet	356.12.500	356.12.700	356.12.300
Surface mount	356.12.590	356.12.790	356.12.390



Order surface mount fitting separately for surface mounting

K Push tech concealed long

K Push tech long with buffer, grey

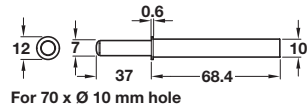

K Push tech long surface mount fitting, white

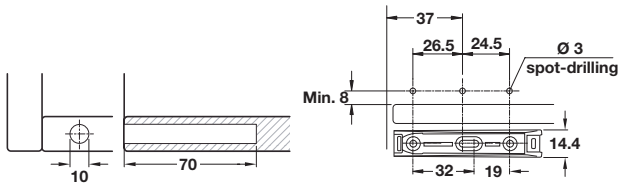
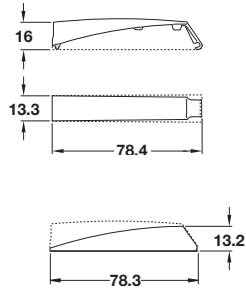

Recess mounted - long

Surface mounted - long



Order surface mount fitting separately for surface mounting

- > Mechanism provides a silent yet powerful operation
- > Suitable for a wide range of doors
- > For installation in a Ø 10 mm hole or order surface mount fitting separately
- > Available either with magnet or with buffer
 - Order magnet version for cabinets using unsprung or negative hinges
 - Order buffer version for cabinets using sprung hinges
- > Important: please do not press or release the spring until the K Push is fully installed
- > Grey, white or anthracite engineering plastic with magnet or rubber buffer
- > Order qty: 1 pc



	Grey	White	Anthracite
With buffer	356.12.517	356.12.717	356.12.317
With magnet	356.12.505	356.12.705	356.12.305
Surface mount	356.12.595	356.12.795	356.12.395

Adhesive plate for magnet

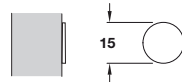

- > Order qty: 1 pc

	Cat. No.
Adhesive plate for magnet	356.01.539

Plate for magnet

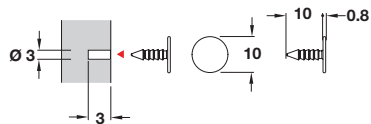

- > Order qty: 1 pc

	Cat. No.
Plate for magnet, with Ø 3 mm pin	356.01.549